



## BY-LAW

NO. 2024 –

---

**Being a By-law to Amend Zoning By-law No. 2003 – 25, being the Comprehensive Zoning By-law for the Municipality of Kincardine**

**Brucelea Poultry Farm Ltd.**

728 North Line (Kincardine Township), Municipality of Kincardine

---

**Whereas** Section 34 of the Planning Act, R.S.O 1990 Chapter 13 authorizes the Councils of Municipalities to enact and amend zoning by-laws which comply with an approved official plan; and

**Whereas** the Council of the Corporation of the Municipality of Kincardine has enacted By-law No. 2003 - 25, a zoning by-law enacted under Section 34 of the said Planning Act; and

**Whereas** the Council of the Corporation of the Municipality of Kincardine desires to amend By-law No. 2003 - 25; now therefore be it

**Resolved** that the Council of The Corporation of the Municipality of Kincardine **enacts** as follows:

1. Schedule 'A' to By-law No. 2003 - 25 as amended, is hereby further amended by changing thereon from 'General Agriculture (A1)' Zone and 'Environmental Protection (EP)' Zone to 'General Agriculture Special (A1-a)' Zone, 'General Agriculture Special Holding (A1-a-H1)' Zone, 'General Agriculture Holding (A1-H1)' Zone and 'Environmental Protection (EP)' Zone on those lands described as CON 3 NDR LOT 43 TO 46, Municipality of Kincardine (Kincardine Township) as outlined on the attached Schedule 'A'.
2. This By-law takes effect from the date of passage by Council and comes into force and effect pursuant to the provisions of the Planning Act, R.S.O. 1990.
3. This By-law may be cited as the "Amendment to Zoning By-law 2003-25 for 728 North Line (Brucelea) By-law".

**Read a First, Second and Third Time and Finally passed** this 9<sup>th</sup> day of October, 2024.

---

Mayor



---

Clerk

# Schedule 'A'

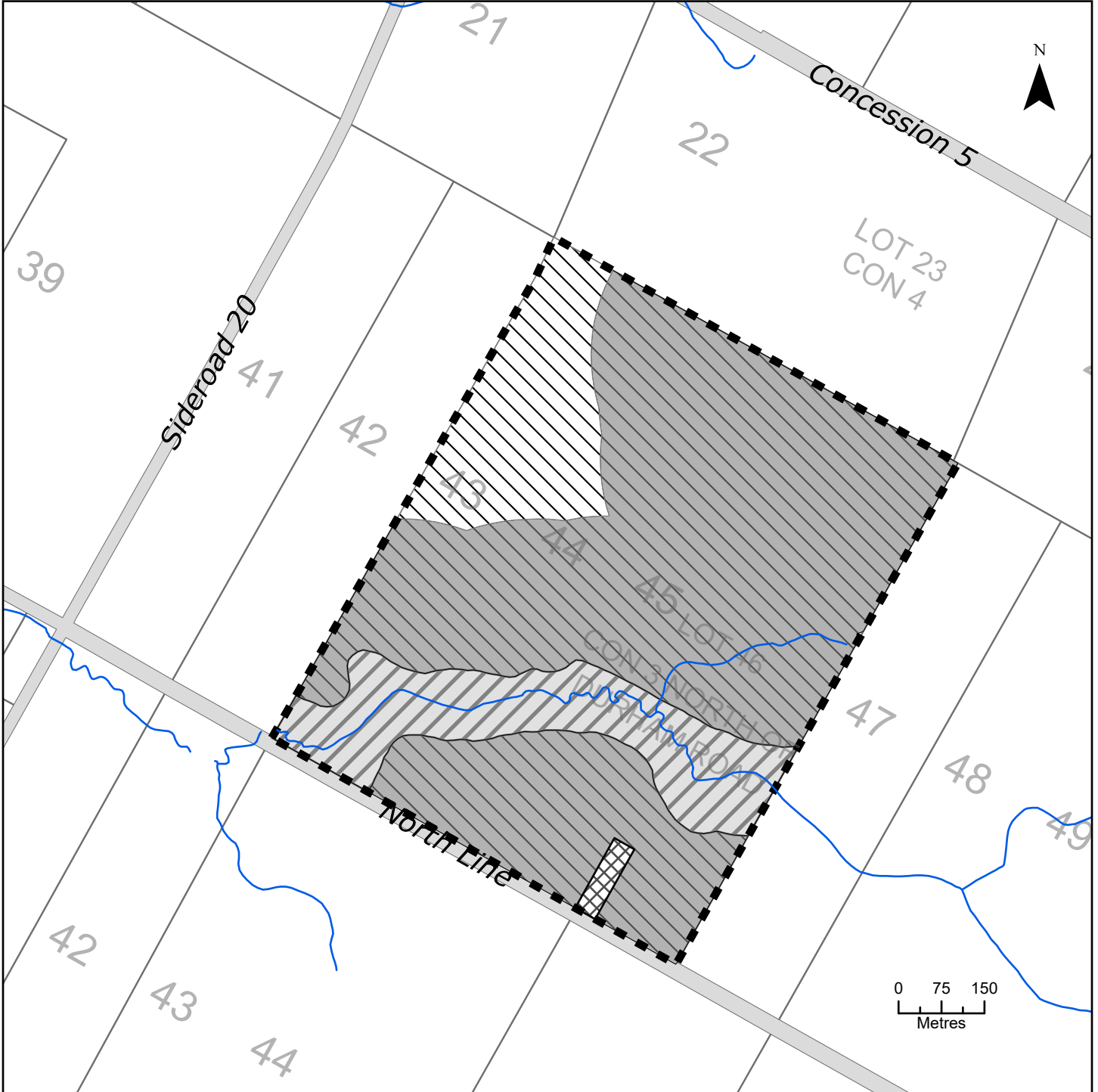
728 NORTH LINE - CON 3 NDR LOT 43 TO 46 - Roll Number 410821000207500  
Municipality of Kincardine (Kincardine Township)

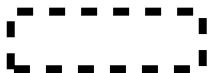
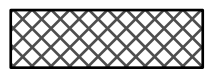
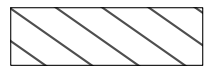
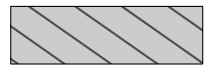

-  Subject Property
-  Lands to be zoned A1-H1 - General Agriculture Holding
-  Lands to be zoned A1-a - General Agriculture Special
-  Lands to be zoned A1-a-H1 - General Agriculture Special Holding
-  Lands zoned EP - Environmental Protection

This is Schedule 'A' to the zoning by-law amendment number \_\_\_\_\_ passed this \_\_\_\_\_ day of \_\_\_\_\_

Mayor \_\_\_\_\_

Clerk \_\_\_\_\_