

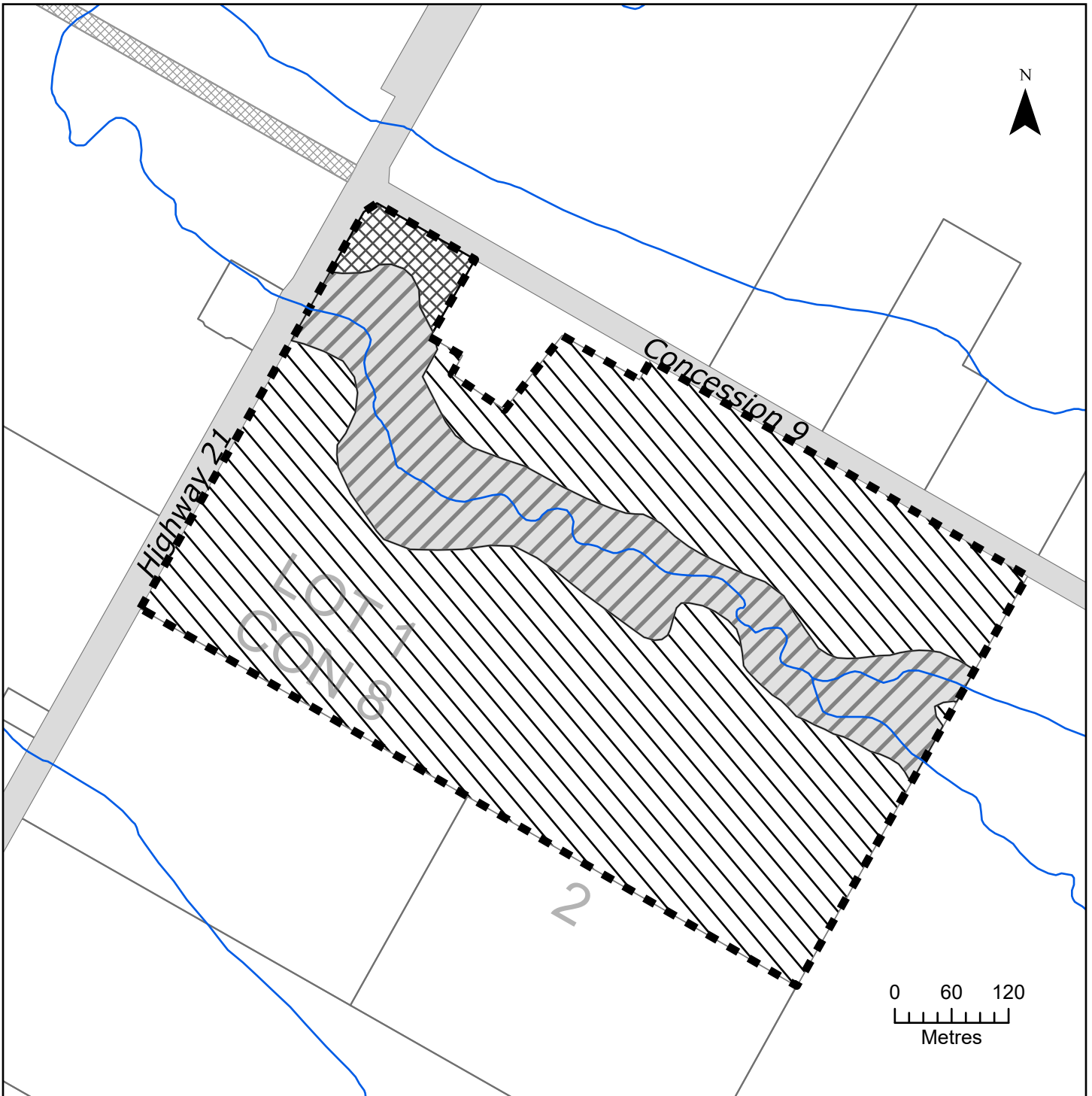

Schedule 'A'

PT LT 1-2 CON 8 KINCARDINE PT 1 3R5710, AS IN R317255 EXCEPT PT 1
3R1008, R197429, PT 7 3R8823, PT 1, PL 3R9699; KINCARDINE;
Roll Number 410821000300400 Municipality of Kincardine (Kincardine Township)

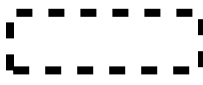
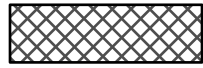

-  Subject Property
-  Lands to be zoned A1 - General Agriculture
-  Lands to be zoned A1-H1 - General Agriculture Holding
-  Lands to be zoned EP - Environmental Protection

This is Schedule 'A' to the zoning by-law
amendment number _____ passed this
_____ day of _____

Mayor _____
Clerk _____