

# Schedule 'A'

5031 HIGHWAY 9 - CON 1 SDR PT LOTS 45 TO 47 -Roll 410821000112800

Municipality of Kincardine (Kincardine Township)

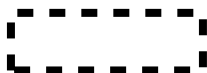
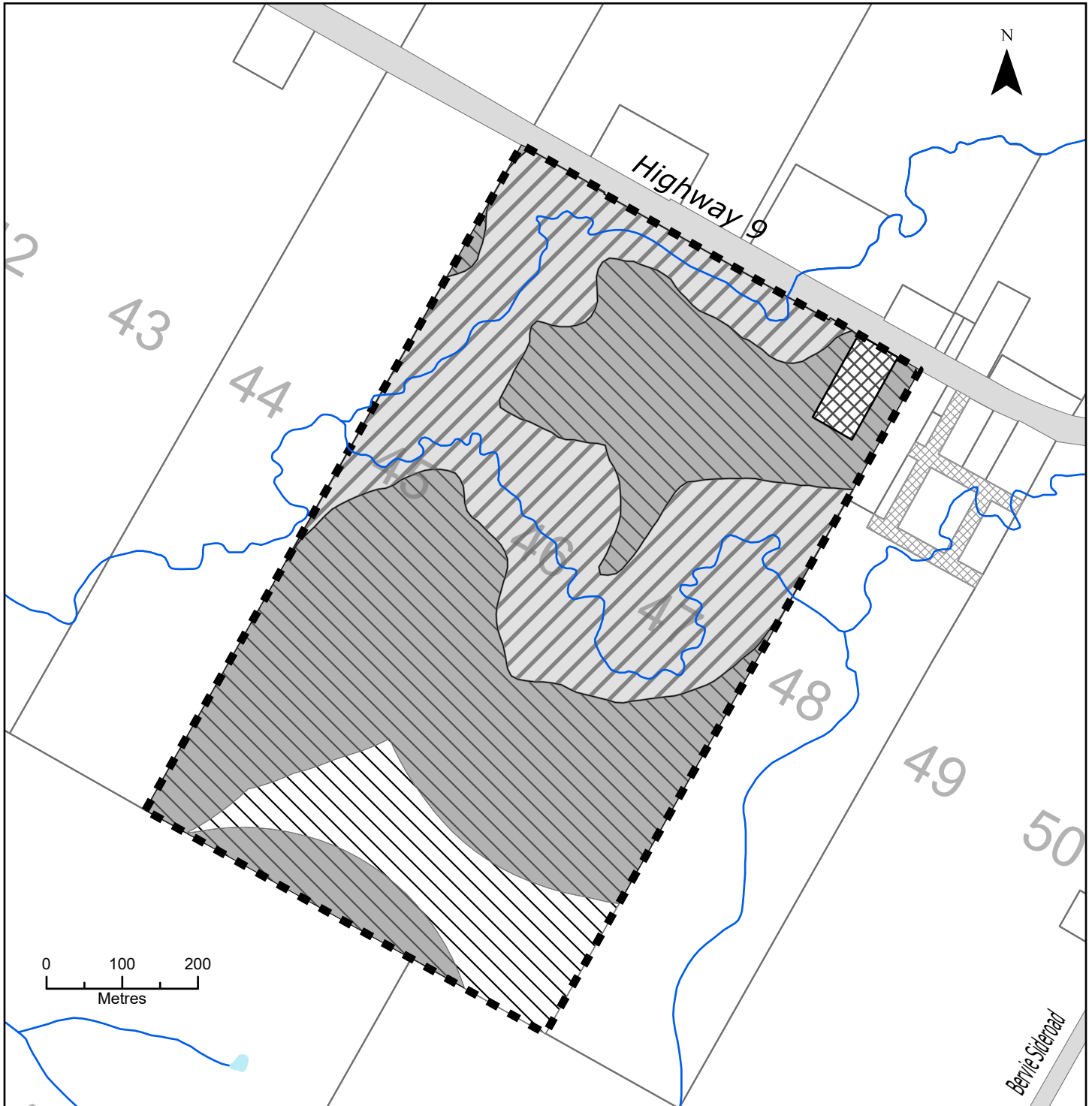

Subject Property



Lands to be zoned A1-H - General Agriculture Holding



Lands to be zoned A1-a - General Agriculture Special



Lands to be zoned A1-a-H - General Agriculture Special Holding



Lands zoned EP - Environmental Protection

This is Schedule 'A' to the zoning by-law  
amendment number \_\_\_\_\_ passed this  
\_\_\_\_\_ day of \_\_\_\_\_

Mayor \_\_\_\_\_

Clerk \_\_\_\_\_