

Do you require an exemption to the Noise By-law? Yes No

If so, please outline request:

As it is a ^{country} music event. we will be playing music from approx 3pm - 1130 pm

Do you require a tent permit? Yes No

Does your event require a Road Closure (ie. Street Festival Closure, Parade Closure, etc)?

Date of Closure: Saturday August 17th 2019

Time Of Road/Route Closure: Aug 17th 2019 830 am

Time Of Road/Route Re-opening: Aug 18th 2019 - 2am

****PLEASE ATTACH A MAP OR USE SITE PLAN SPACING BELOW, INDICATING THE ROAD CLOSURE/PARADE ROUTE****

Site Plan (Please provide as much detail as possible)

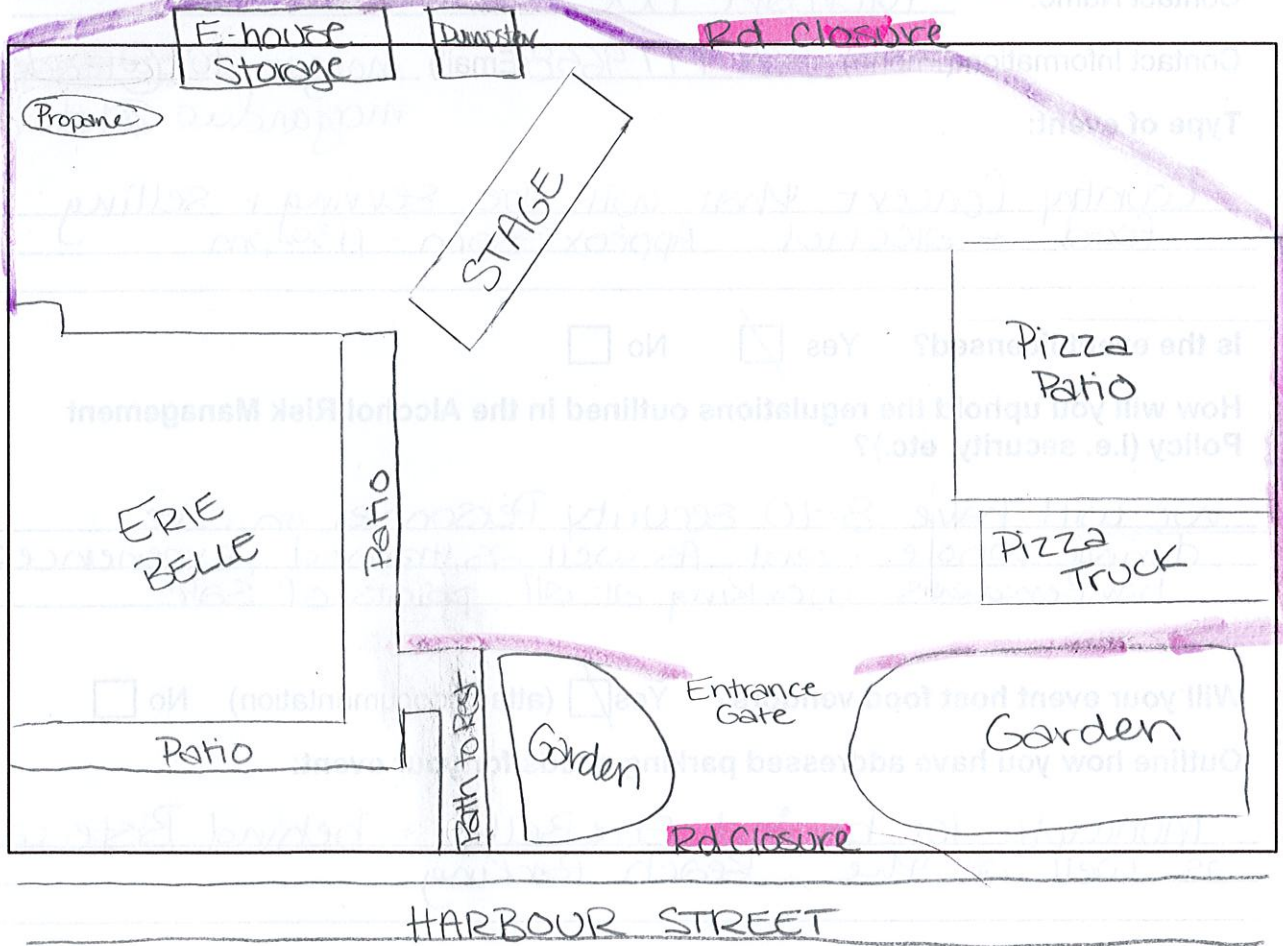

 = where fencing will go